

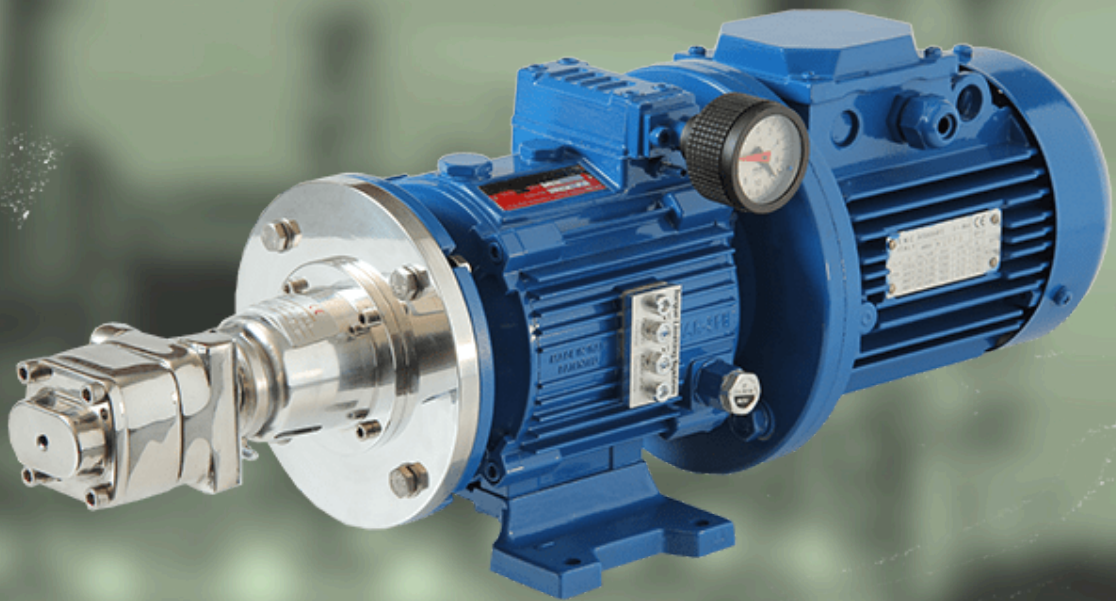

GEAR TRANSFER - WP SERIES

PUMP RANGE



WP SERIES PUMP RANGE



CUCCHI GEAR TRANSFER PUMPS



- ∞ FLOW RATE <480 L/HOUR
- ∞ PRESSURE 15 BAR
- ∞ FOR MEDIUM VISCOSITY LIQUIDS
- ∞ HIGH SELF-PRIMING POWER
- ∞ MODULAR DESIGN

Part of the
CUCCHI GEAR TRANSFER
Pump Range



N SERIES



F SERIES



B & MG SERIES

The WP Series gear pumps by Pompe Cucchi are designed to deliver high-precision metering and dosing in a wide range of industrial processes. These rotary positive displacement pumps are known for their modular construction, which allows for easy integration into complex systems and ensures long-term reliability across diverse applications.

Engineered for accuracy, the WP Series guarantees consistent volumetric delivery, making it ideal for sectors such as chemical processing, pharmaceuticals, food production, and cosmetics manufacturing. Each pump is constructed from robust materials, including AISI 316 stainless steel, with the option for hardened gears to withstand abrasive or high-pressure media.

Thanks to its modular design, the WP Series can be configured with magnetic drives or mechanical seals, and can be customized with heating jackets, different gear materials, and a range of port connections to meet specific process requirements. These pumps are also self-priming, with excellent suction capabilities that allow them to handle both viscous and non-lubricating fluids with ease.

∞ TECHNICAL SPECIFICATION

MODEL	CAPACITY (L/H)	CONNECTIONS	R.P.M	KW ABSORBED			WEIGHT (KG.)
				5 Bar	10 Bar	15 Bar	
WP 2	120	3/8" BSP	1450	0.09	0.14	0.18	1.9
WP 4	240	3/8" BSP	1450	0.14	0.19	0.24	2.4
WP 8	480	3/8" BSP	1450	0.19	0.24	0.35	2.9

WP SERIES PUMP RANGE



CUCCHI GEAR TRANSFER PUMPS

PARTS LIST

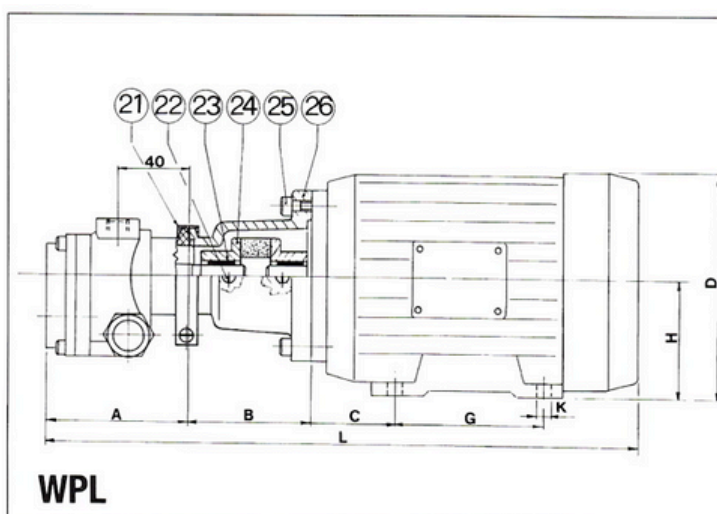
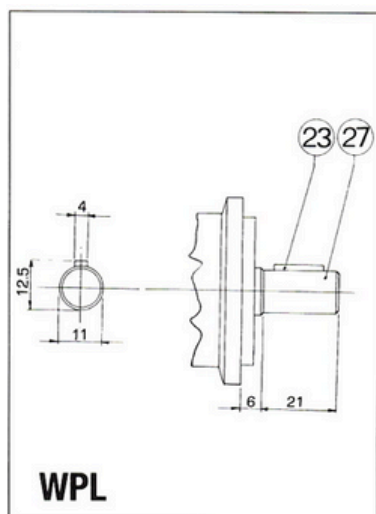
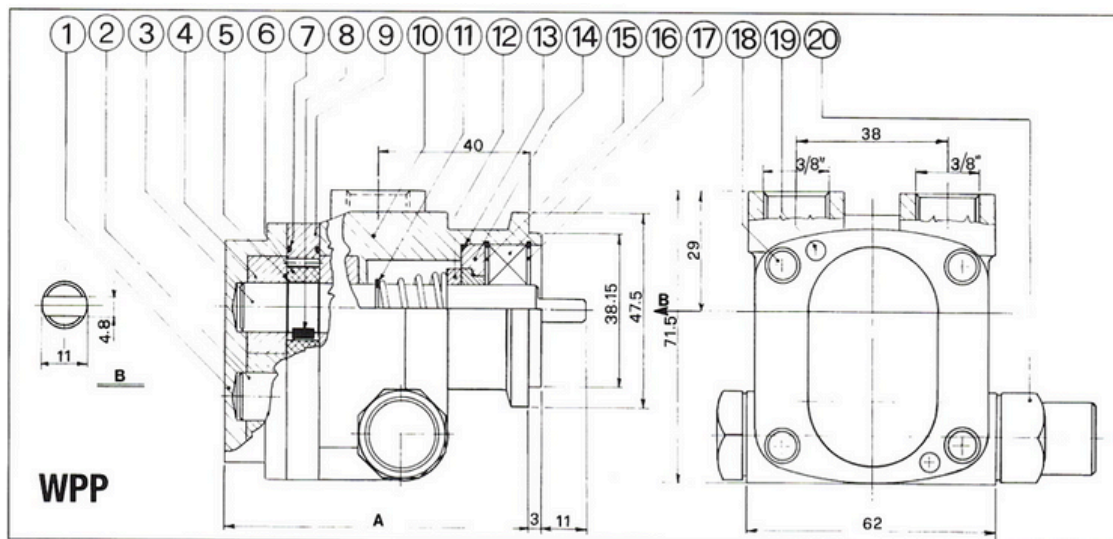

- | | |
|--------------------|-------------------|
| 1 Cover | 15 Seeger |
| 2 Driven shaft | 16 Ball bearing |
| 3 Driving shaft | 17 Seeger |
| 4 Bush | 18 Bolt |
| 5 Seeger | 19 Pin |
| 6 Gear | 20 Valve |
| 7 O.Ring | 21 Clamping plate |
| 8 Key | 22 Headless screw |
| 9 Central body | 23 Key |
| 10 Flanged body | 24 Joint |
| 11 Seeger | 25 Bolt |
| 12 Mechanical seal | 26 Strainer |
| 13 O.Ring | 27 Driving shaft |
| 14 Ring | |

WP SERIES PUMP RANGE



CUCCHI GEAR TRANSFER PUMPS

∞ RANGE DIMENSIONS

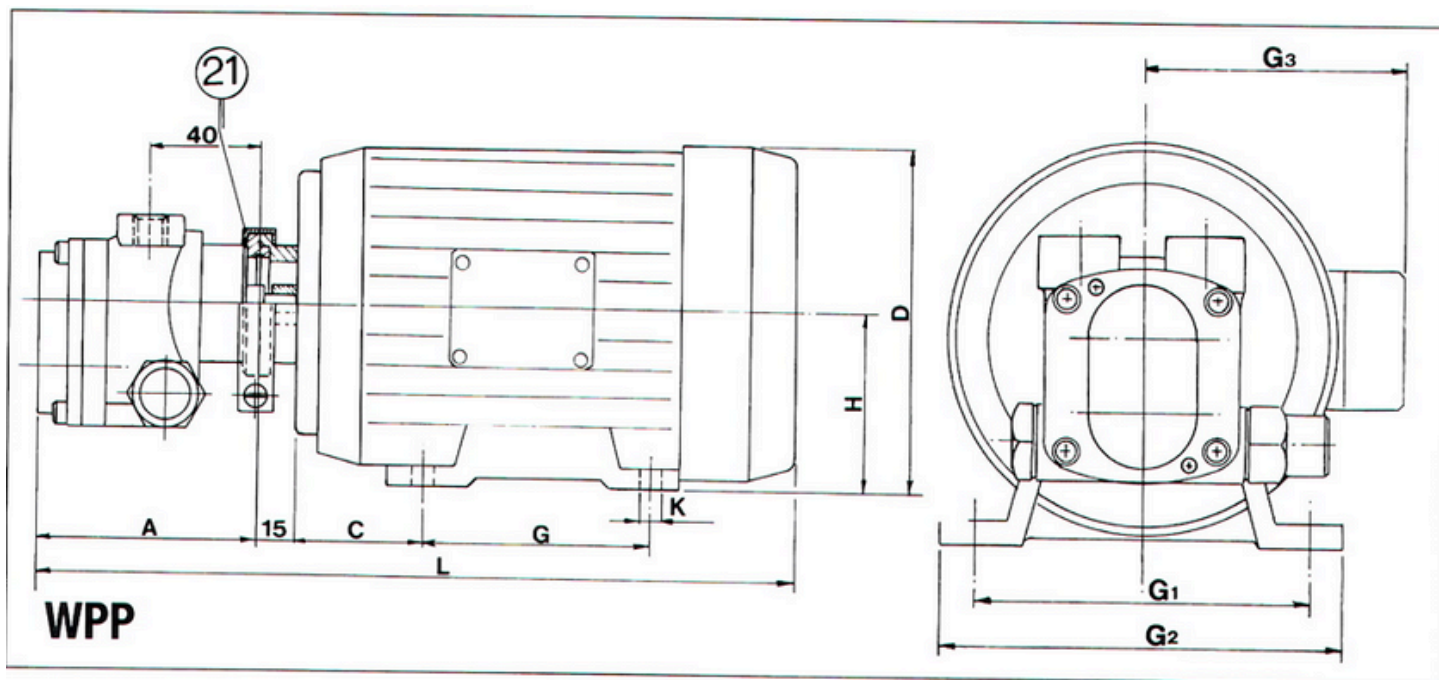

MODEL	A	B	C	D	G	G1	G2	G3	H	K	L	MOTOR SIZE	PUMP WEIGHT	MOTOR WEIGHT
WPL 2	86	66	40	125	80	100	125	96	63	7	340	63	1.8	9.5
		78	45	138	90	112	136	113	71	7	375	71	2.0	14.0
		81	50	156	100	125	153	133	80	9	403	80	2.2	19.5
WPL 4	93	78	45	138	90	112	136	113	71	7	382	71	2.4	14.0
		81	50	156	100	125	153	133	80	9	410	80	2.5	19.5
WPL 8	106	81	50	156	100	125	153	133	80	9	423	80	2.8	19.5
		92	56	176	100	140	171	153	90	8	450	90.S	3.4	25.0
WPP 2	86	-	40	125	80	100	125	96	63	7	289	63	1.4	9.5
		-	45	138	90	112	136	113	71	7	312	71	1.4	14.0
		-	50	156	100	125	153	133	80	9	337	80	1.4	19.5
WPP 4	93	-	45	138	90	112	136	113	71	7	319	71	1.7	14.0
		-	50	156	100	125	153	133	80	9	344	80	1.7	19.5
WPP 8	106	-	50	156	100	125	153	133	80	9	357	80	2.0	19.5
		-	56	176	100	140	171	153	90	9	373	90.S	2.0	25.0